

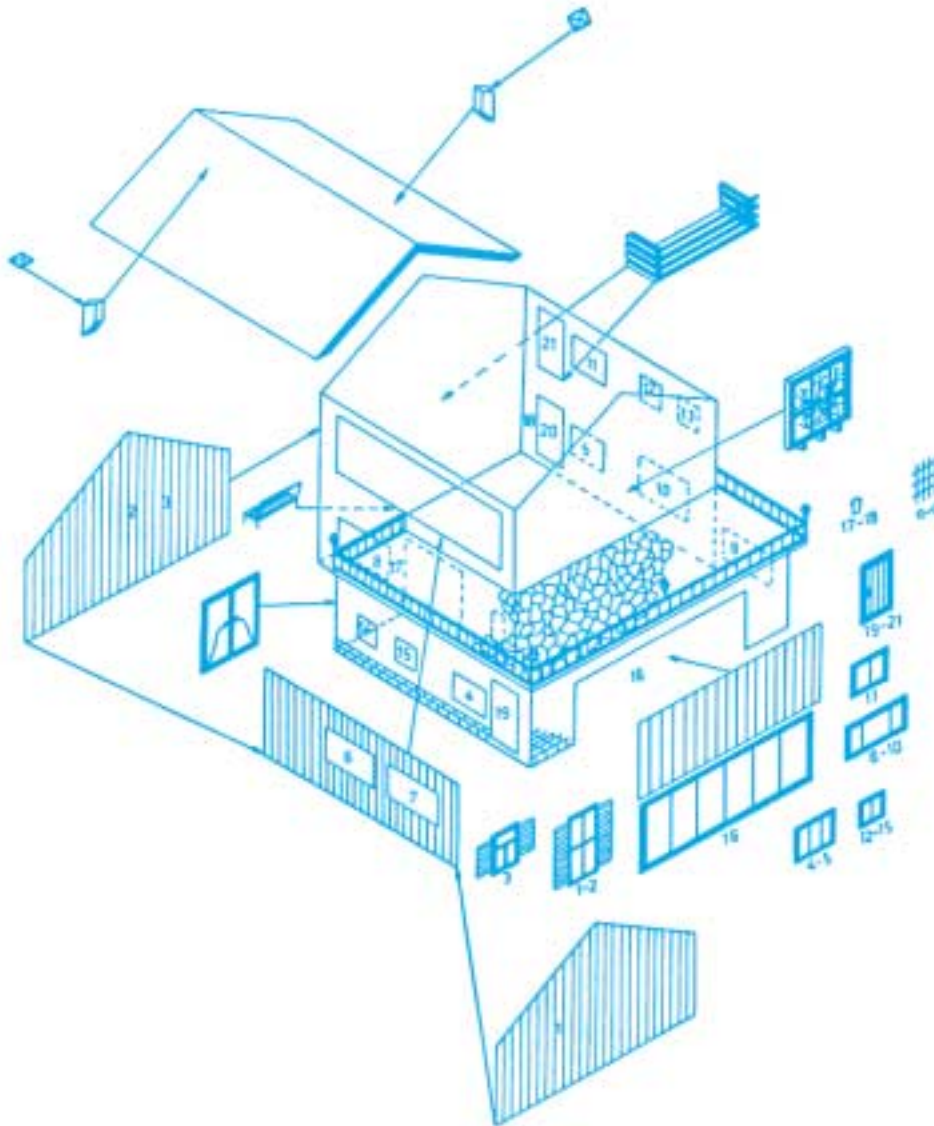

ReadyMade

INSTRUCTIONS FOR EVERYDAY LIFE



A MAGAZINE FOR PEOPLE WHO LIKE TO MAKE STUFF

www.readymademag.com
call toll free (866) 851-3369

ReadyMade

PREVIEW ISSUE

INSTRUCTIONS FOR EVERYDAY LIFE

WHY NOT?

- ↗ Make Your Computer Light Up
- ↗ Send Yourself A FedEx Full of Cash

BEYOND DIY

- ↗ Put Old LPs In The Oven
- ↗ Build A Bed On Wheels

LIVE BEYOND YOUR MEANS
[Their Trash. Your Treasure.]



Tints

Cyan %
Magenta %
Yellow %
Black %

Paint Code

3 AM

0
0
0
100



Siren

0
90
100
0



Brick

5
100
100
15



40

A BRIEF HISTORY OF CONCRETE

Plus 4 ways to pour concrete at home.

by Augustus Haywood Rose

44

BUILD A MEAT CART BED

Easier than you'd think!

by ReadyMade

48

DINGBAT CULTURE

The minidramas of L.A. architecture.

by Mimi Zeiger

52

THE FUTURE OF DIY

Things that will build themselves.

by David Pescovitz

58

MAKE ART OUT OF YOUR TV

It deserves a podium.

by Tony Discenza

62

I'M AN UNLICENSED THERAPIST. HERE'S MY CARD.

3 do-it-yourself career paths.

by Josh Green

66

BUILD A SHADOWBOX FRAME

Kodak moments for under \$10.

by Adrian Van Allen

68

STUFF YOUR PET

Taxidermy 101.

by Shoshana Berger

80

THIS IS THE LIFESTYLE SECTION OF THE MAGAZINE

But please, don't call it a "lifestyle loft."

by James Chiang



44



48



80



ReadyMade

Preview Issue



FRONT OF BOOK

10	FIRST READ THIS	An apology from the editor for not calling more often.		
12	AD LIB LETTERS	You fill in the blanks.		
15	READY, SET, GO	FedEx wallets; LPs turned coasters, bowls, and boxes; AOL diskettes; DIY toupée; photo-op book; "40 Things I'll Do When I Get the Hell Out of This Apartment"		
24	READYMADE UP	Smelly Money: Curator David Gissen's fantasy art project.		
28	RE WIRE	A computer drive bay lamp. <i>by Steve Dodds</i>		
30	POST-MARTHA	"Good Things" gone bad. <i>by Adrian Van Allen</i>		
32	MAKE A PANTY LAMP	Brings the sheer energy of old panty hose to light. <i>by ReadyMade</i>		
36	Q&A	Fifteen minutes with Jimmy Corrigan, smartest kid on earth, and Chris Ware.		



28



24



15



15

BACK OF BOOK

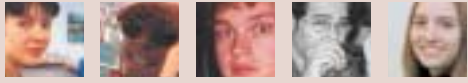
84	HOW TO SEEM SMARTER IN 5 EASY STEPS	Sample dialogue included. <i>by Jenn Stroud Rossman, Ph.D.</i>		
87	WHAT WE WERE THINKING	A monthly index of influences, roadside attractions, and arcana that plug up the drafty, hole-punched parts of our brains.		
90	OUR CONTRIBUTORS: GOD THEY LOOK GOOD			
92	FOUND ON THE STREET: WHY DON'T PEOPLE LIKE ME?	Will the person responsible for this please call us?		
94	INDEX	Things you may have missed.		
95	RESOURCES	Where to find sheet metal at four in the morning.		
96	UNMADE	The postman rings 43 times. <i>by Evan Ratliff</i>		

An Apology for Not Calling More Often



PG = Polish grandmother



RM = ReadyMade

PG: I've been trying to get ahold of you. You're impossible to get ahold of.

RM: I know. I'm sorry. I've been busy.

PG: What is it?

RM: I'm still trying to start this magazine.

PG: What do you call it?

RM: *ReadyMade*.

PG: "Ro Vac"?

RM: No. R-e-a-d-y-M-a-d-e. I'll send you a card with the name on it.

PG: You should send me something. I never hear from you anymore.

RM: I'll send you a card. How are you feeling, Grandma?

PG: Like an old lady. Are you meeting interesting people?

RM: Yes.

PG: Jewish?

RM: A few of them, yes.

PG: That's wonderful. So, what is it, this magazine?

RM: It's an instructional manual for how to make things. I myself started reading instructions only recently, which explains many things. But one night, while watching a Discovery Channel special on the ingenious things bears do before hibernating, I decided it was time for an instructional magazine. These two events may be related, I'm not sure.

The same thing happened in the dairy section of the supermarket when I bumped into a person I had known in high school but had not seen for many years. This person got considerably worked up telling me about the independent film he was working on. It was about his childhood as a musical prodigy. I stood there watching his hands flap up and down on imaginary keys and thought, This person used to be OK, but now I'd like to kick him in the shin.

Because I am well socialized and know that violence is wrong, I just smiled at him, trying to find pity. Two weeks later, I bump into this same person outside a movie theater and the experience is altogether different. This time he wants to hear my thoughts on the European film we have both just seen. I say it had too few chase scenes, even if the stars all had great bone structure. The film person nods and smiles. Then he buys a *Street Sheet* from a man who looks cold.

PG: —

RM: Now I am confused and find myself looking at this former child prodigy in a wholly different light, thinking this may even be the lead-in to a story I'll end up telling to young people after 40 years of trust and companionship with someone whom I once had wanted to kick in the shin.

They'd beg me to tell the story again and again, and I would, adding a flourish here and there, perhaps giving him a beret during the supermarket part. Does this make me an untrustworthy narrator? It does not. On the contrary, my young friends would support my refurbishing of the facts, as facts too can get that unrefreshing feeling.

So the draw of the magazine, of *ReadyMade*, the stories and the instructions, is the draw of improbable endings. The bit of string connecting A to B. The private elation one feels from having made a whole out of a clutter of parts, of rescuing something from the scrap heap and seeing a gem-like flame of invention in everything.

PG: So the people are interesting?

You're meeting them?

RM: Yes.

PG: Good. What are you doing for exercise?

RM: There's a store down the block. We often need milk.

PG: I'm having problems with my legs.

I'm going in to see the doctor tomorrow so he'll give me something.

RM: What's the matter?

PG: Something with the legs.

RM: I'm sorry. I'll try to call more.

PG: What does it mean, "Ro Vac"?

— Shoshana Berger

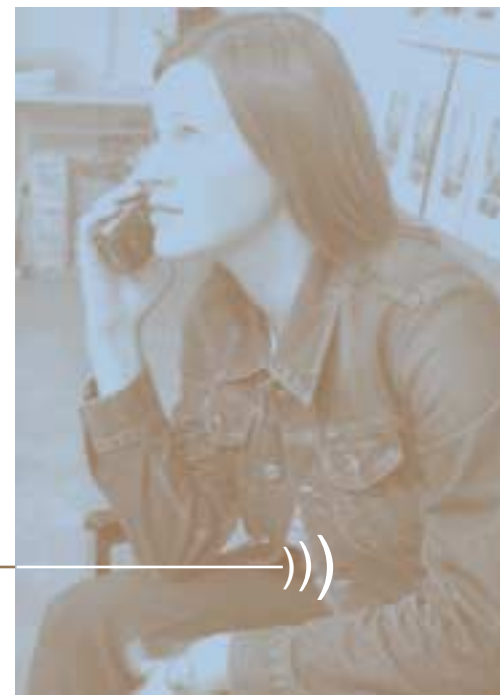

READY

SET

GO

A NEW SPIN ON OLD LPs



COOKING WITH WAX



1. LP BOWL

1. Choose an LP with a colorful label. **2.** Clean the LP with soap and water; dry well. **3.** Preheat the oven to 350°. **4.** Lightly oil one side of the LP (peanut oil is preferable, but any oil will do). **5.** Place the LP oiled-side-down on the cookie sheet. **6.** Set timer for 1 minute and 35 seconds. **7.** Put the cookie sheet into the oven and start the timer. **8.** After 45 seconds, flip the LP over so it heats evenly. **9.** When the time is up, take the LP off of the cookie sheet and begin molding, turning up the sides to create a wavy bowl shape. The bowl should not be too hot; if it is, wearing gloves does the trick. (Caution: Do not wear plastic gloves.) You have only 20 to 30 seconds of playtime to shape the bowl, so be nimble. **10.** If your bowl looks wrong, put it back in the oven for another 10 to 15 seconds. That will give you more playtime. **11.** If your bowl is still lopsided, put the LP back in the oven until it wilts into its original flat form and start again. **12.** The finished product will be smaller than you might expect. In-house research has shown that three bananas, one large apple, or four heads of garlic will fit into the average bowl.

design by Sherif Shalaby

✓	INGREDIENTS: LP BOWL	
	OLD SCRATCHED-UP LPs	
	POT-HOLDER GLOVES	
	PEANUT OR ANOTHER OIL	
	COOKIE SHEET	
	OVEN	



THE BOX SET

DUST OFF. DRINK ON.



2. LP BOX

1. Make a mark on the back of the LP cover 1/4" in from each of the edges and trim using the ruler and X-acto knife. You should have two clean, straight-edged pieces. **2.** On the backs of the pieces, measure 2 1/2" in from the edges. Mark four straight folding lines. **3.** Repeat with the second piece, adding 1/16" for a snug-fitting box (2 9/16") or 1/8" for a loose-fitting box (2 5/8"). **4.** Turn each piece over and place a strip of tape over each fold line to prevent the sleeve from cracking when folded. Burnish with your thumbnail or a spoon until the tape is invisible. **5.** Cut tabs at the corner fold lines. **6.** Using a ruler as a guide, fold over all four fold lines, including the corner tabs. **7.** Lay the pieces flat and cut the felt to fit the interior sections. **8.** Glue the felt into place. Position the sections between two pieces of waxed paper and let dry overnight under the weight of an encyclopedia, your VCR, or any heavy object at hand. **9.** On the inside of the corner tabs, find the center and punch a hole. Repeat for the front and back tabs until you have eight holes per sheet. **10.** Grommet these holes together. If the edges of the tab do not lie flat after grommeting, carefully glue closed.

inspired by Pad: The Guide to Ultra-Living , by Matt Maranian

✓ INGREDIENTS: LP BOX	
LP DUST JACKET	GROMMETS & GROMMET GUN
BLACK FELT (2 SQ FT)	CLOTHESPINS
2" WIDE PACKING TAPE, CLEAR	GLUE
PENCIL	MEDIUM-SIZED PAINTBRUSH
RULER	WAX PAPER
SCISSORS	
X-ACTO KNIFE	



3. LP COASTERS

SAFETY FIRST! DO NOT TRY THIS AT HOME WITHOUT A SKILLED SHOP PERSON BY YOUR SIDE. WE ARE TRYING TO BE HONEST WITH YOU NOW SO YOU WON'T COME POINTING YOUR REMAINING THREE FINGERS AT US. IF YOU ARE UNSURE ABOUT YOUR DRILL PRESS SKILL LEVEL, BUT FEEL THAT YOU NEED LP COASTERS—THAT LIFE WILL BE INCOMPLETE WITHOUT THEM—PLEASE COME VISIT THE READYMADE WEBSITE AND BUY A SHINY SET FROM US: WWW.READYMADEMAG.COM.

1. Dust off the LPs and sing them a soft lullaby before they die and are reborn. **2.** Attach the hole saw to your drill of choice (a drill press is the obvious choice, but it can be done with a handheld drill as well). **3.** Use the C-clamps to clamp the LP to a piece of scrap wood and a stable work surface. Put on the safety goggles and respirator mask—vinyl dust is bad for you. **4.** Drill out the center of the record, using the center spindle-hole as your guide. And *please* watch your fingers.

design by Adrian Van Allen and David Shanks

✓ INGREDIENTS: LP COASTERS	
A SET OF OLD, BUT UNWARPED VINYL LP'S	1 PIECE OF SCRAP WOOD AS LARGE AS THE RECORDS
4 1/4" INCH HOLE SAW	1 SHEET 200 GRIT SANDPAPER
ATTACHMENT FOR AN ELECTRIC DRILL OR DRILL PRES	CAN OF SPRAY VARNISH
ELECTRIC DRILL OR DRILL PRESS	SAFETY GOGGLES
2 SMALL C-CLAMPS	RESPIRATOR OR FACE MASK

RE

WIRE

O.K. COMPUTER LAMP

by Steve Dodds

Sometimes scavenged materials lend themselves to a new use so well, you almost forget they had a former life. This holds true for the metal frame I found on a pile of discarded computer parts while walking home from work one day. Its proportions, perforations, and mounting holes spelled lamp to me, not drive bay for a motherboard. And unlike your new computer, that will be landfill within a year or two, this Lite-Brite-like fixture is a keeper.

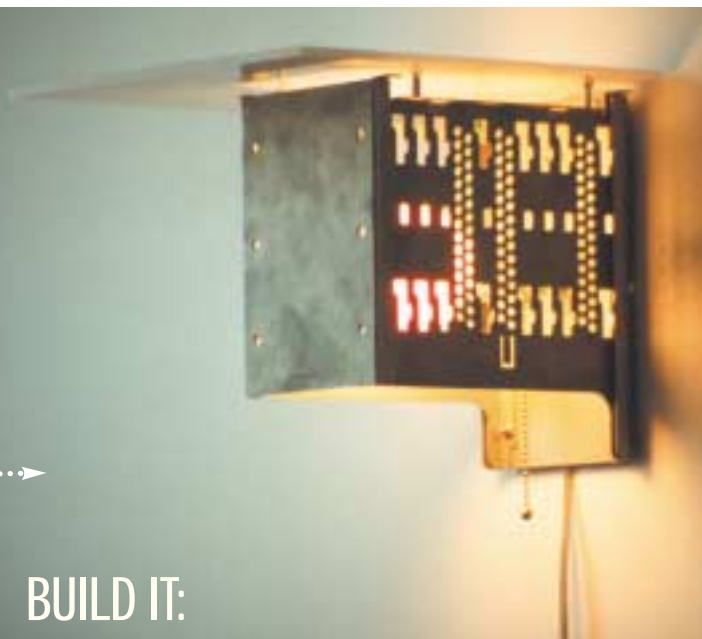
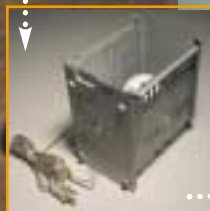
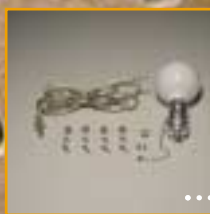

✓ TOOLS: DRIVE BAY LAMP

Tools:

Electric drill

Assortment of drill bits

Adjustable wrench

Screwdrivers to fit each type of screw

Pencil

Square

Small round file

✓ INGREDIENTS: DRIVE BAY LAMP

1 Computer drive bay

1 1/4" x 11" x 11" Piece Plexiglas

4 1/2" gray rubber bumpers

4 1/2" oval head machine screws

(head must fit into bumpers)

4 Nuts to fit oval head machine screws

4 1" flat head machine screws

(size to fit threaded inserts on drive bay)

4 Nuts to fit flat head machine screws

1 Pull-chain light socket

1 1/2" threaded lamp nipple

1 Lamp nut

1 Length of lamp cord

1 Plug

1 40-watt light bulb

1 Plastic wall anchors

1 Screws to fit anchors

anchors that require a 1/4" hole in the wall and accommodate #10 screw drill size will suffice.

1 Frosty beverage of your choosing

BUILD IT:

1. Stumble across a drive bay or other sheet-metal frame, strip it of its parts, and clean it thoroughly.
2. Look in the yellow pages and find a store that sells plastics. Paw through their scrap bin to get the Plexiglas. The 1/4" opalescent acrylic casts a nice light. Find a size that fits the salvaged frame you're using.
3. Bring the frame to the hardware store and get the remaining hardware, making sure the screws fit through the holes and studs in the frame.
4. On the back of the frame, mark a location for the center of the light socket and a spot above and below it for screws to attach the frame to the wall.
5. At the light socket location, drill a hole large enough to accommodate the lamp nipple. Do this incrementally: Start with a small bit and drill the hole larger and larger. Otherwise you'll be at it all night. File off any burrs.
6. Drill the two holes in the frame for the mounting screws. File off any burrs. If you want to spray-paint it, now is the time.
7. On the protective paper covering the Plexiglas, lay out locations for holes that correspond to the threaded studs on the top of the frame. Make sure that the Plexiglas doesn't extend past the back of the frame.
8. Begin drilling the holes with a large bit to countersink the flat head screws, but be careful not to drill all the way through. Finish by drilling the rest of each hole to fit the shank of the screw. Peel off the protective paper.
9. Now you're ready to put it all together. Thread the lamp nut onto the nipple, poke it through the hole, and thread the bottom of the socket on the other side.
10. Pass the lamp cord through the nipple, wire the socket, and assemble it. Put the plug on the other end of the cord if it didn't come with one.
11. Using the short screws, attach the rubber bumpers to the back of the frame.
12. Open a frosty beverage and scout for a location to mount this thing.
13. Install the wall anchors and hang the lamp. The bumpers should hold the lamp far enough away from the wall to allow the cord to turn and run down the back of the frame.
14. Screw the Plexiglas into the threaded studs on top of the frame. Place a nut on the screw between the Plexiglas and the stud to act as an additional spacer.
15. Screw in a bulb. Plug it in. Turn it on and finish your frosty beverage. Don't forget to recycle.

RE RE RE

USE

FEDEX WALLET

OVERNIGHT SATISFACTION GUARANTEED

by Rachel Hutton

Last year it was UPS brown, now everyone covets those blue and orange FedEx-issue uniforms. But if you're considering going postal and becoming a courier just to get the logo, please try making this FedEx wallet first—it brings the satisfaction of guaranteed overnight delivery to your back pocket.

INSTRUCTIONS:

Reevaluate why you're carrying so much crap around in your wallet. Make a mental note to pare down emotional baggage (time to let go of the video rental card from the neighborhood you lived in two years ago).

Then get a Tyvek FedEx Pak at your day job or your friend's day job.

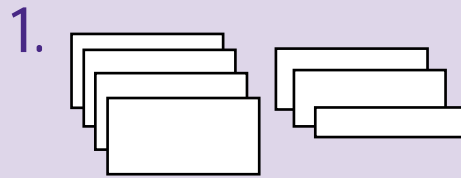

1. Cut the Pak into rectangles of the following dimensions (consider which panels will be visible and crop accordingly):
 4 7 1/2" x 3 1/2" 1 7 1/2" x 2 1/2"
 1 7 1/2" x 2 3/4" 1 7 1/2" x 1 1/2"

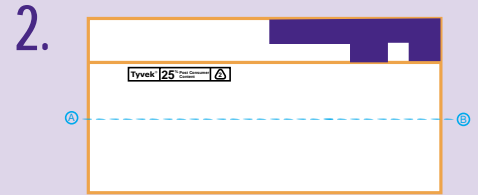

2. Place the 2 3/4" panel on top of one of the 3 1/2" panels (you're making the first card-holding panel) with the bottom edges flush. Stitch horizontally 1" from the bottom edge.

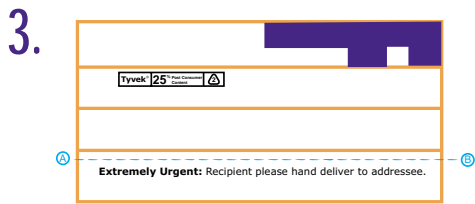

3. Place the 2 1/4" panel on top of the panel you just sewed, flush with the bottom edge. Stitch 1/2" from the bottom. Then place the 1 3/4" panel on top, with bottom edges flush. Pin or hold in place while you stitch the next step.

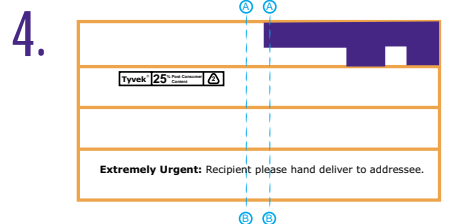

4. Mark the center of the wallet and make two vertical stitches: the first 1/8" left of center, the second 1/8" right of center.

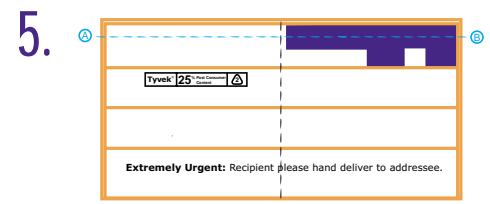

5. Place the card-holding panel on top of another large rectangle and stitch horizontally along the top edge (finishing the front panel).

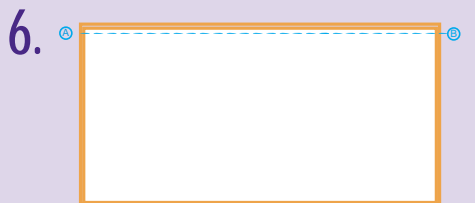

6. Place the two remaining large rectangles on top of one another and stitch horizontally along the top edge (same as the previous step) to create the back panel.

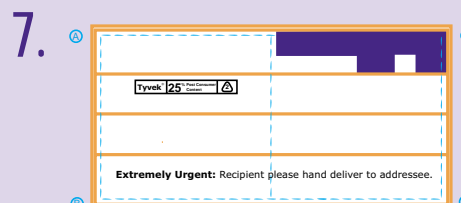

7. Place the front panel on top of the back panel and stitch together along the remaining three sides (insert a credit card and mark seam location to insure a snug fit before sewing).

✓	INGREDIENTS: FEDEX WALLET
	1 TYVEK FEDEX PAK
	SEWING MACHINE
	(sewing by hand is fine, just a bit tedious)
	SCISSORS
	THREAD



before



after



READYMADE UP *

FOR CURATOR DAVID GISSEN, MONEY TALKS. IT SMELLS AND TASTES, TOO.



ONE OF THE BEST PERKS of the new millennium was the introduction of mint-fresh money. We now have a new twenty, a new ten, a new five, a quarter with a Georgia peach on the back, and a shiny “gold” dollar coin. But beyond the obvious pleasures of collecting the full set, the new money has done little to change the larger design concept of currency—the design of the transaction. Like its predecessor, the new money is still made to be held, considered, and handed over, a gesture we carry into more immaterial forms of spending, such as e-commerce.

This new age of numismatic ephemerality begs the question of what else might be in store for the Benjamin. Will it pass between us in the form of odor, taste, or touch and be exchanged with a kiss, a sniff, or a handshake? The images seen here are examples from a larger art project that examines the future of transaction. Some make spending easier, others make it more fun. “Smelly Money” privileges

scent (useful for the visually impaired), while “Phone Card Gum” provides a time-sensitive oral sensation for the those who still think talk is cheap. The phone call lasts as long as the gum does—5 minutes of phone-bill-flavor.

David Gissen wants to bring his exciting and provocative design thinking to you! As the associate curator of architecture and design at the National Building Museum and principal of the eponymous D. Gissen Designs, he explores aspects of human conveyance and materiality including money, elevators, escalators, vehicles, and moving sidewalks. He divides his time between New York City and Washington, D.C.



PHONE CARD GUM: Chicklet-style gum is tattooed with a calling card number and a code. Dial the number, then enter the code. Both the call and the flavor of the gum last exactly 5 minutes.

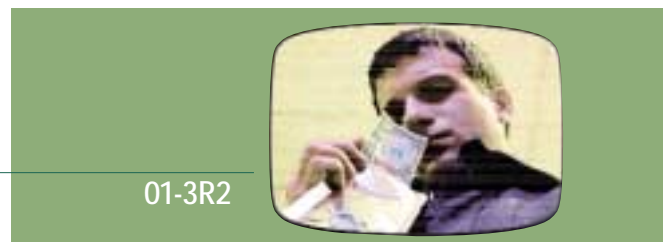

01-3R2



07-2R5

SMELLY MONEY: Paper money is infused with an odor, allowing the blind to differentiate between values of currency. One-dollar bills smell like cherries, five-dollar bills smell like lemons, and so on. A special re-sealable Mylar wallet keeps Smelly Money fresh.



FREEBORD MANUFACTURING INC. ★

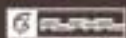

FREEBORD™

SHOWBOARD THE STREETS



CONNECTION: ●●●●●●●●

FOR LINE: 415 285 2673 FAX LINE: 415 642 0714
WATCH THE RIDE: WWW.FREEBORD.COM

FB-ALPHA™ ●
●●●●●●●●

EDUC 8877

input:○○○○○○○○○○

0100000000



DL 0000
FILE
BLUE
RED
BLACK
WHITE

FORMAT: FILE: 0000000000000000

DL
INFORMATIONAL BITS



WELCOME: WE DESIGN FOR THE PEOPLE, SO YOU CAN REST EASY. SMILES EVERYONE, SMILES!
© 2001 DIGITAL LAUNDRY MAT. MADE IN THE U.S.A. PLANET EARTH. SPACE 0 SAYS "HI"
WWW.DIGITALLAUNDRY.COM - 800DIGITALLAUNDRY.COM - 415 826 0971



digital laundry mat® - design™



LIV YOUR LAUNDRY



text and Polaroids by **Mimi Zeiger**



As I drive up and down the streets between Pico and Olympic boulevard the cliff-hanger hopes of Los Angeles are laid bare to me through its names. Names of neighborhoods, buildings, and streets, but especially of dingbats.

That's why I'm cruising. I'm hunting dingbats on these over-exposed strips—dodging Hasidic Jews on their way to *schul* and Latino boys zipping in and out of carports on Razor scooters. They all live in dingbats. The dingbat is the brick and mortar of the melting pot.

“What’s a dingbat?” you ask. It has two meanings: a stupid or easily confused person, and stupid or easily confused decoration. In L.A., it’s both Pamela Lee and the Pamela Apartments. Flat, windowless facades propped up on spindly legs that taunt the unstable tectonic plates below.

Dingbat apartments are built icons of the postwar era. Their facades are as much painted lady as any Victorian, but by way of Joan Crawford, not the Queen Mum. They wear their accessories—star-shaped wrought iron, carriage lamps, decorative tile, coats-of-arms—like clip-on jewelry. Baubles and broaches designed to emulate a glamour just beyond reach.

Then there are the names. Not all dingbats have names, but the ones that do announce them in gilded cursive. To distinguish one pastel, insurance-company’s nightmare from the next, midcentury developers chose names invoking social mobility. Plain stucco apartment buildings were dubbed the Landmark or the Manor. A landmark of what? A developer’s cheap attempt at a buck executed in pink stucco? Or just a sad attempt to establish some sort of grounding in a land where the earth shakes and the pictures move.

As I turn onto Sherbourne, “Sherbourne Gardens” scrolls across the screen in sweeping calligraphy, the grandeur of the script compensating for where the architecture comes up short. It’s like the naming of towns in the great westward migrations that gave



DINGBAT DEFINED: Critic Reyner Banham attributes the term dingbat to architect Francis Ventre. Banham wrote the 1971 urban scan *Los Angeles: The Architecture of Four Ecologies* while himself living in a dingbat.



rise to Milan, Tennessee; Morocco, Indiana; and Paris, Texas—European immigrants trying to make a life out of sorry clumps of dirt. Bootstrapping one's station in life is, of course, 100 percent American. A three-car pileup of manifest destiny, trailblazing cowpokes, and *The Jeffersons*.

So it seems right that in Los Angeles, where the frontier ends in an irrigated desert ripe with expectancy, the naming of places would take hold and flourish with baby-boom abandon. Dingbats came into their own during the golden age of television and

and good-bye. I'm trying to figure out if it's welcome to Fantasy Island or a send off for those going further west. When you hit the outer edges of the American continent, names become like koans.

I lived in the Pacifica Apartments in Santa Monica for a while. It was a dingbat made tasteful in flat gray and flat blue. Affordable and modest—at the time it was rent-controlled—it wore no name or ornament on its front side. The only sign of its dingbat-hood



DINGBATS CAME INTO THEIR OWN DURING THE GOLDEN AGE OF TELEVISION AND WERE MODELED AFTER THE LITTLE BOXES THAT KEPT TIME IN HALF-HOUR SEGMENTS. THEY ARE MINIDRAMAS OF DOMESTICITY.



were modeled after the little boxes that kept time in half-hour segments. They are minidramas of domesticity.

I head to Santa Monica, slowing down for the best of them and taking snapshots. A few blocks from the beach, but without much of a view, I find the Ocean Aire Terrace and the West Winds. The salty fog rusts their copper signage, but their optimism is ineffaceable.

There is only one that really throws me: Aloha, emblazoned across the blankest of blank white stucco, with a star flourish like an asterisk. It's neither *the* Aloha, nor the Aloha Winds, nor the strange but somehow fitting Aloha Manor. It's simply Aloha. Hello

was on the lease agreement and the monthly check I made out to the Pacifica Real Estate agency. The apartment was comfortable enough, but something was missing: that coulda-been-a-contender quality spelled out in tin letters and colored lights.

For me it's the sad, faded dignity of the apartment buildings that makes this plasticky City of Angels seem like a livable place. A place where names are no longer placeholders for a better tomorrow, but first editions of the American dream, executed in shades of turquoise and dusty rose. 🏠



Intrepid girl-reporter Mimi Zeiger is the editor of architecture zine loud paper.



MEAT CART BED

SLEEPS 2 PLUS A PORTERHOUSE



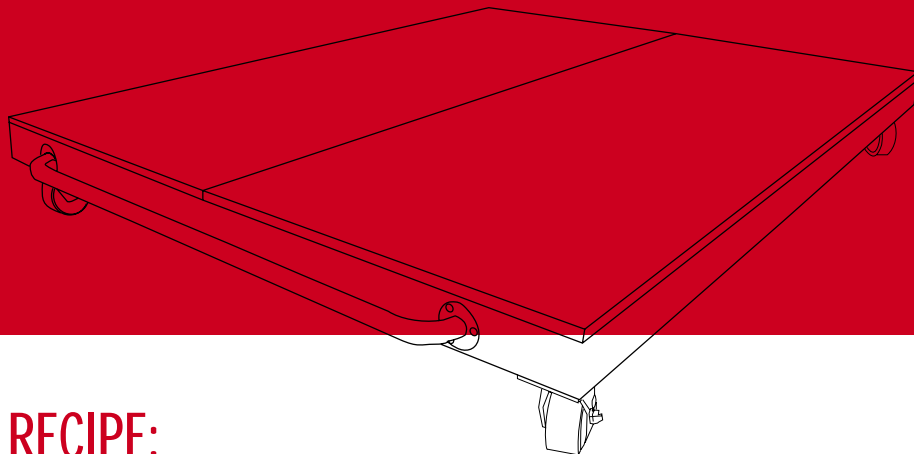

PROJECT INFO

WHAT: Meat Cart Bed

WHO: ReadyMade

ASSEMBLY TIME: 16 hours
(You could have taken the two-day course: "Getting Comfy With Curves")

EXPERTISE LEVEL:



RECIPE:

This bed is designed to accommodate a queen-size mattress. ReadyMade apologizes for not providing instructions for smaller people with single and double beds, nor for the more ambitious king-size-bed people.

1. Go to a big hardware store that will make cuts for you. Assemble all of your lumber and mark your cuts with a pencil. Take it to the person in charge of cutting things and watch closely as he or she cuts it. It's very important that the cuts be accurate.
2. Measure your front door and the door to your bedroom. If the dimensions of the bed (72" x 84") won't fit through, you'll have to build it where it's going to live.
3. Lay out all the 2" x 4" beams in the pattern indicated (see next page). Pre-drill two holes 1" apart where the beams meet, then screw 3" wood screws into the pre-drilled holes. Follow the same procedure for all four corners. Before tightening the screws completely, make sure that the corners are truly square by placing the T-square at the corner beams.
4. Place the three 69" cross-beams in equidistant thirds from the head and foot beams. Screw into place. Place 45°-angled beams at the four corners and screw into place from inside the frame.
5. Place the casters at the four corners of the frame, making sure to set the two locking ones on diagonal corners. Pencil in the screw holes for the casters and pre-drill them with a beefy drill bit. With the adjustable wrench, screw the casters in place using the lag bolts and washers. Be patient, this could take a while.
6. Now you should have a sturdy frame. Stand back a moment and look at your accomplishment. God, you're good. Now it's time to spread out the tarp. Place the plywood sections on it carefully so that they form one big 6' x 7' rectangle. Screw the sections together with the T-straps and 1/2" screws, making as tight a seam as possible.
7. Get a friend to help you lift the frame onto the plywood rectangle. (Tip: Use the casters as handholds.) Attach the frame to the plywood platform using the 1" L-brackets and 1/2" screws.
8. If you don't get enough already at the office, attach the fluorescent tube lights to the underside of the frame using 1/2" screws. Use the socket splitter to plug both lights into the 50' orange extension cord. Tack any extra cord to the beam using a staple gun. Be careful not to puncture the cord or the ply (see figure 6 on next page).
9. Now that the frame is securely attached to the plywood, flip it over so it's resting on the casters. You can barely contain your excitement now. Look at that. Sand the top of the platform lightly to remove the odd splinter. For a more finished look, tape off a rectangle approximately the size of your mattress (about 1' should remain outside the tape on each side). Brush on one or two thin coats of clear varnish, leaving the section bounded by the tape unfinished (this will prevent your mattress from sliding around during, er, more "active" Meat Cart activity). Allow 8 hours drying time between each coat. If your work-space isn't well ventilated, wear a respirator or protective mask. Safety first.
10. Once your cart has dried, center the chrome handicap bar on the side you'll want to be dragging it around by, then screw it into place. Tap in the roofing-nail-and-washer combos over the unsightly wood screws.
11. By now you are very tired. You are raw and meat-like. It's time to lie down.

OPTIONAL STEP: In the 1' perimeter of plywood that borders the space for your mattress, try using a 3" hole-saw attachment for your electric drill to cut a glass-size hole near the head of the bed. Use different hole-saw attachment sizes to fit a tapered flower vase or a glass of milk (the wholesome, vitamin D-enriched stuff).

✓	TOOLS: MEAT CART BED
	Electric drill
	Adjustable wrench
	Drill bits corresponding to screw sizes
	Hole-saw drill attachments (optional)
	Screwdriver
	Small T-square
	Furry Ear Muffs (this may get rather loud)

✓	INGREDIENTS: MEAT CART BED
	LUMBER
	2 3/4" x 36" x 84" high-grade raw birch plywood
	2 2" x 4" x 81" kiln-dried pine beams
	3 2" x 4" x 69" kiln-dried pine beams
	4 2" x 4" x 7" kiln-dried pine beams cut at 45° angles at the ends*
	HARDWARE
	1 Box 3" wood screws (approx. 50).
	1 Box galvanized roofing nails w/ attached washers
	1 Box 1/2" wood screws
	8 1" L-brackets
	4 6" steel T-straps
	6 2" x 1/2" lag bolts and washers
	OTHER STUFF
	4 5" casters, two with locking mechanisms (we like the red ones)
	1 36" chrome handicap bar (look for a salvage one)
	1 9' x 12' tarp
	1 Pack 100-grit sandpaper
	1 Pint clear varnish
	1 3" paint brush
	OPTIONAL STUFF
	2 36" fluorescent tube lights (you can find these at salvage yards too)
	1 Socket splitter
	1 50' orange electrical cord
	1 Roll 1/2" masking tape
	1 Respirator or protective mask
	1 Glass of milk or flower vase (tapered)

* (These can be cut from the scraps of your other beams. The length you'll need depends on the size of your caster base, i.e. they must be as long or longer than the metal plate base of your caster.)

Build a MEAT CART BED

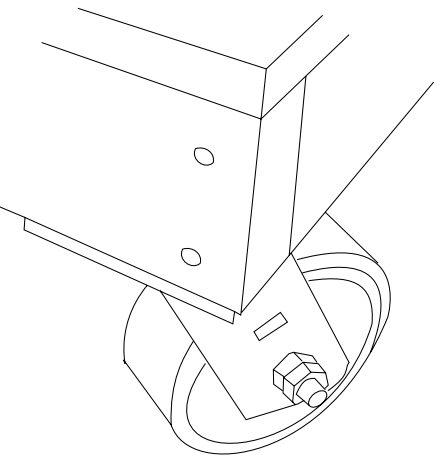
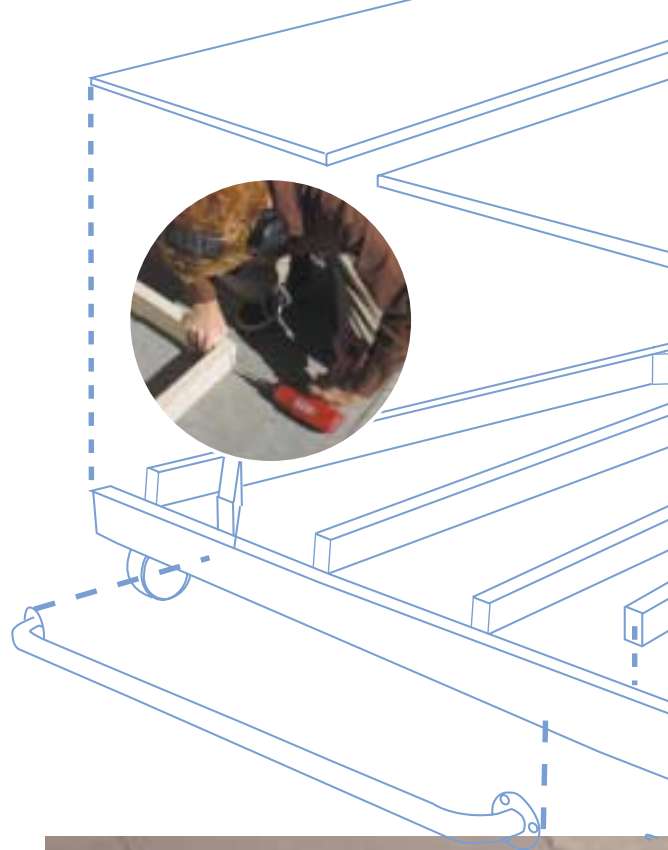

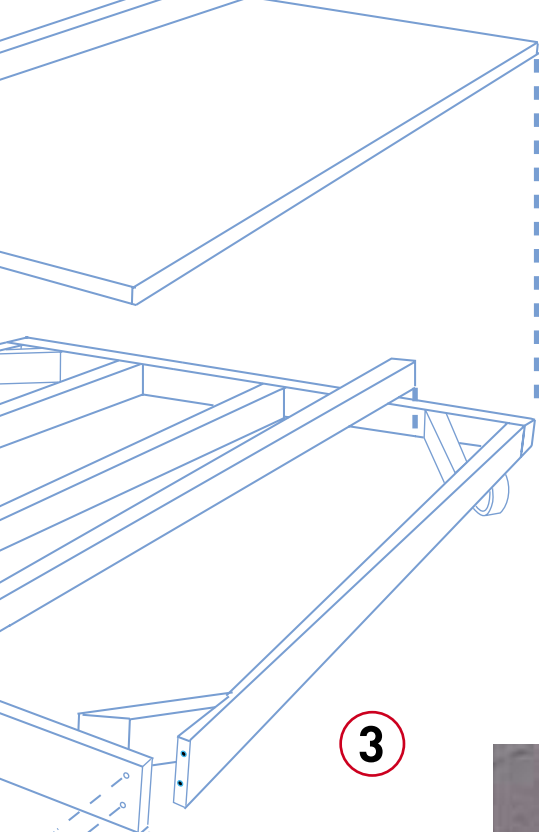

SLEEP: RAW FACTS

Clinophobia This is fear of going to bed. We're still looking for the word for fear of waking up.

Beds for Bessy Farmers are buying up cow-cots stuffed with shredded auto tires, which would otherwise be landfill, to keep dairy queens comfy and thereby increase milk production.

Dreaming: Better Than Acid When people are wakened repeatedly during episodes of rapid eye movement, they tend to hallucinate during daylight hours. REM time also causes a loss of muscle tone during sleep, which amounts to a temporary paralysis. Researchers have suggested that this keeps us from acting out our dreams.

Lose Weight While You Sleep! Scientists have discovered genes for hibernation in humans. The discovery could pave the way for cryo-sleep of the kind foreshadowed for astronauts in the 30-year-old film *2001: A Space Odyssey*. Hibernation would make ultralong-haul space travel a possibility, with crews effectively put to sleep for months or even years by triggering the deep-sleep genes that man's distant ancestors used to survive severe winters. The U.S. military, which has been funding the research, is interested in the concept of inducing hibernation to keep wounded soldiers alive until treatment is at hand. And researchers in Britain are investigating whether the role of genes in the loss of body fat during hibernation could lead to a new miracle diet.

More Hibernation Facts A butt plug made of poo, dead intestinal cells, hair, leaves, pine needles, and bedding material helps hibernating bears keep themselves fresh during the big sleep. Because we know it's important to have all of the facts, here's this: Where does it go? The lower colon. How long is it? One inch.

Counting Sheep Average people fall asleep in seven minutes. That's why they're average.

The Sleep-Wake Cycle (A good band name!)

In 1972, geologist Michael Siffre stayed in an underground cave for six months to see if it would affect the typical 24-hour-day sleep-wake cycle. He shifted to 48- to 50-hour days, during which he was awake 33 to 36 hours and slept 12 to 15 hours. That amounted to a gain of almost an entire month's worth of alert time. Imagine all the things you could do with an extra month down there in that cave! "I was thinking that since I was a scientist, I could better control my data and reactions," Siffre says. "In fact, I could not." Traumatized by the isolation, silence, and lack of time cues, Siffre says it took him five years to recover from the effects of his cave studies.

This Is the Lifestyle Section of the Magazine

by James Chiang

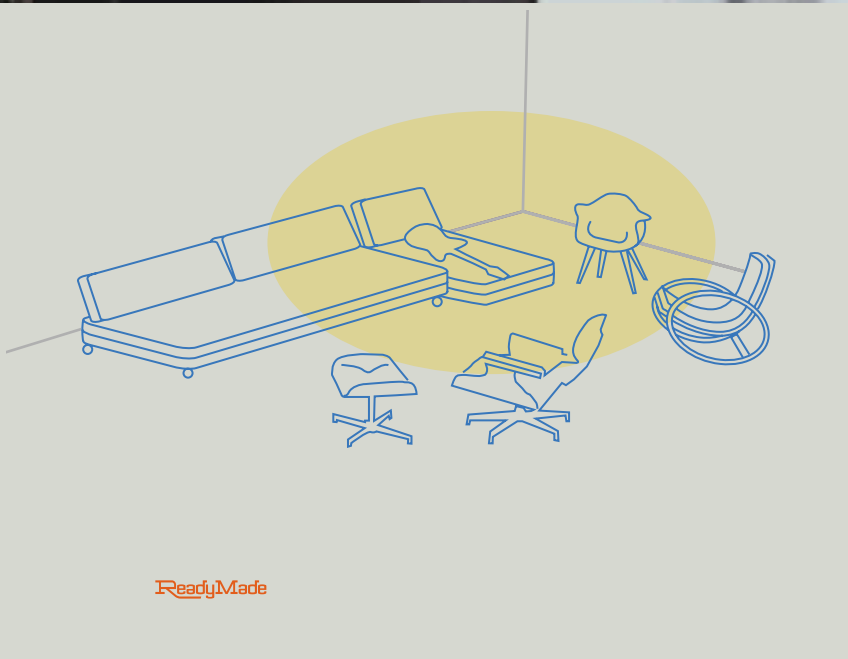

When photographer James Chiang landed a pre-dotcom-priced, raw live-work space in San Francisco's SoMa district, it was more for the DIY potential than for the T1 line. With help from garden-variety industrial catalogs and a few able-bodied friends, he built out a living space that doubles as a gallery—showcasing Mao-era Chinese cameras, obsolete electronics, and mid-century furniture finds. But please, don't call it a "lifestyle loft."

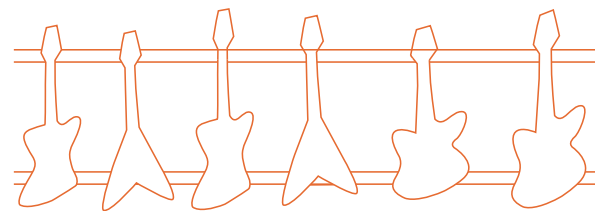
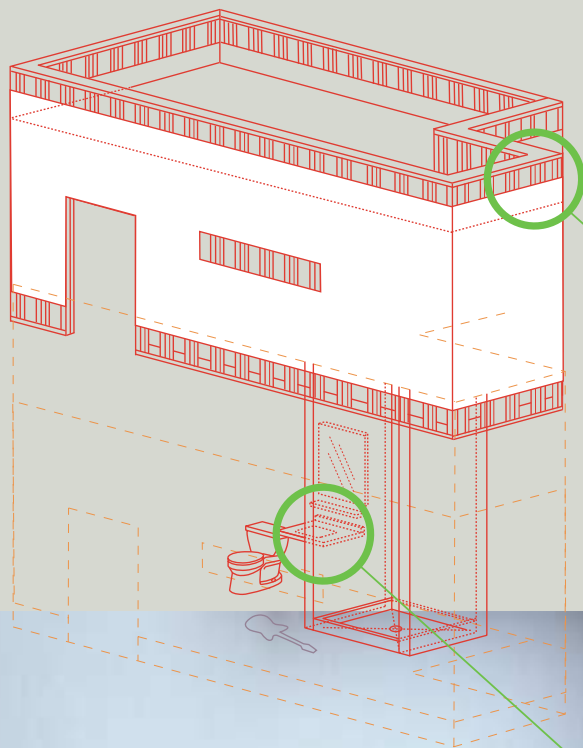

fig. A

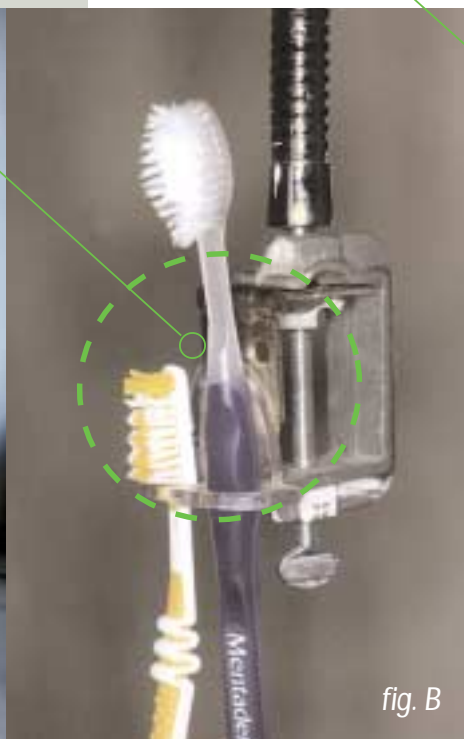

fig. B



fig. C

I built most of this stuff myself with the help of some generous friends. The materials I chose were unfussy and available locally or by mail order. All of the furniture was either salvaged, stolen, or bought at a discount.

Figure A shows a hodgepodge chair I assembled from the cushions of a '50s Goodform¹ chair I found at Goodwill and a cheap knockoff of a Mies van der Rohe² Barcelona chair nabbed from a modern-furniture dealer. Armor All did wonders in restoring the vinyl's original luster.

The toothbrush holder shown in figure B was cobbled together from standard hardware-store materials: a gooseneck lamp extender, a light base clamp, and a disassembled wall-mounted toothbrush cup. Curious, yet functional.

In figure C a 3/4" sheet of birch plywood was affixed to metal studs. The studs were used purely for effect; wood sections were removed to reveal the steel support structure. A basic oil-based Varathane stain was used to give the wood an aged, yellowish cast.

The loft in figure D (see next page) was constructed from common plumbing pipes and structural fittings made by Hollaender.³ The Rolex of fixtures, Hollaender couplings average \$15 apiece, and carry an interior-quality finish that you won't find in standard fittings. Cruder alternatives can be purchased through Global Supply⁴ for about \$8 each. The loft flooring in figure D is C-D grade birch ply, which is rough around the edges, but thick and cheap. A 1/4" top layer of birch veneer was used to make the surface splinter-safe.

The guitar amplifier and CPUs in figure E were covered with vinyl spray paint purchased at an auto body shop. Vinyl spray paint is typically used to refinish car seats, but I use it to cover the pukey beige of computer casings, since it dries without the puddling or streaking common to household spray paint. Plus, it gives everything that new-car smell.

Ignoring the possible health hazard, I made the desks in figure E out of medium-density fiber wood.⁵ The supports consist of plumb pipes and cast-iron fittings ordered from Global Supply.

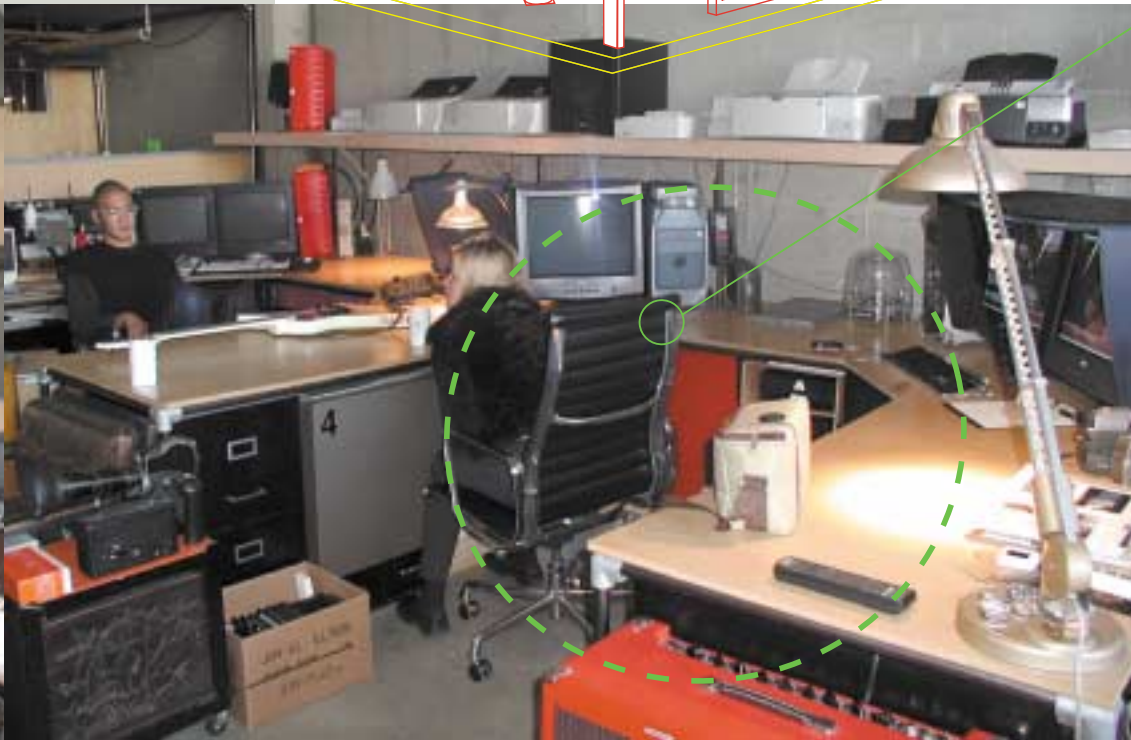
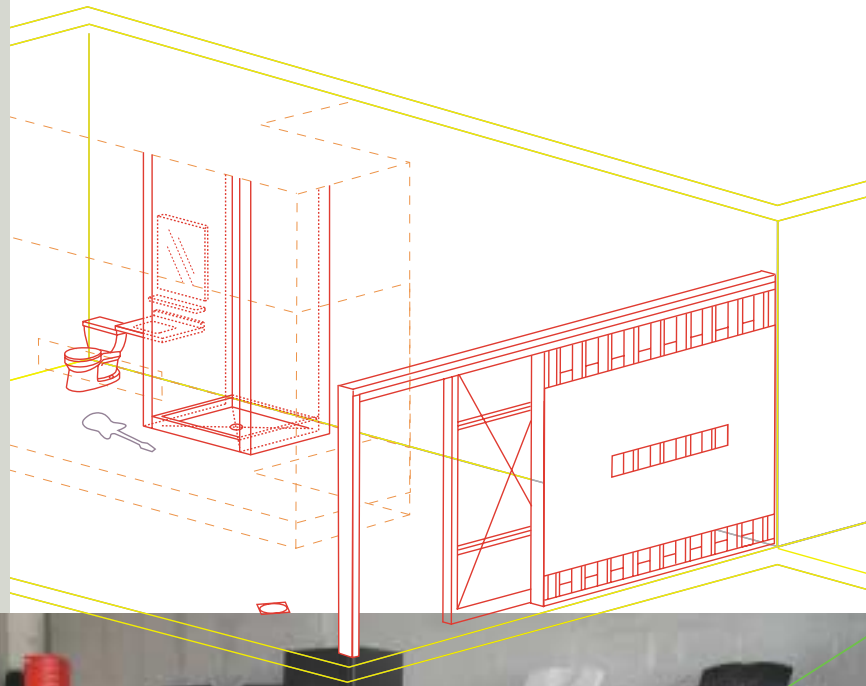
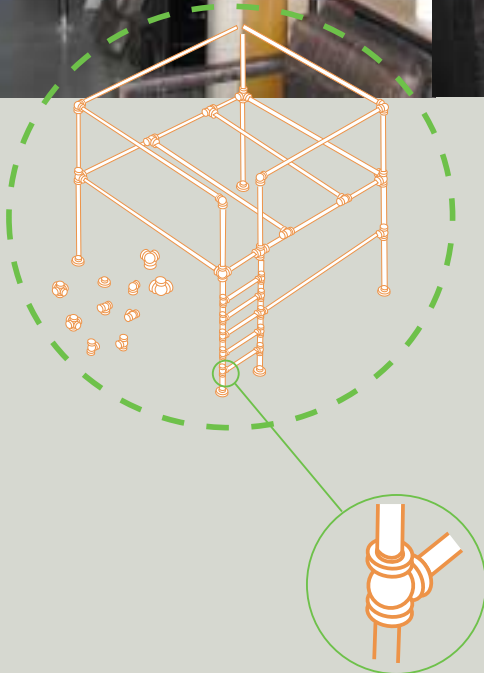



fig. D

fig. E



A cluster of midcentury modern furniture is what figure F amounts to, none of which was bought through traditional retail channels. The Eames⁶ lounge chair was “salvaged” from a large corporation that had too many of them to keep count. The Eames shell dining chair was filched from a street corner, while its leather-bound cousin was had for \$10 from the San Francisco city recycling program. The base for the lounge-height shell chair is a reproduction ordered online from Circa50.⁷ Marrying a reproduced Eames base with a found Eames shell will save you hundreds of dollars. And it’s amazing how well they get along.

The pendant light fixtures were made by Holophane⁸. I switched out their industrial-strength high-intensity discharge⁹ ballast to accommodate standard, mogul-base screw-in bulbs for residential use. A trip to the salvage yard should turn up the fixtures to make this conversion, though I’d recommend having an electrician do the talking. The pleasures of high-intensity discharge should be left to a trained professional. 

New Yorker James Chiang, together with Londoner Julian Quayle, makes up the San Francisco-based death metal photographic team DOVE.

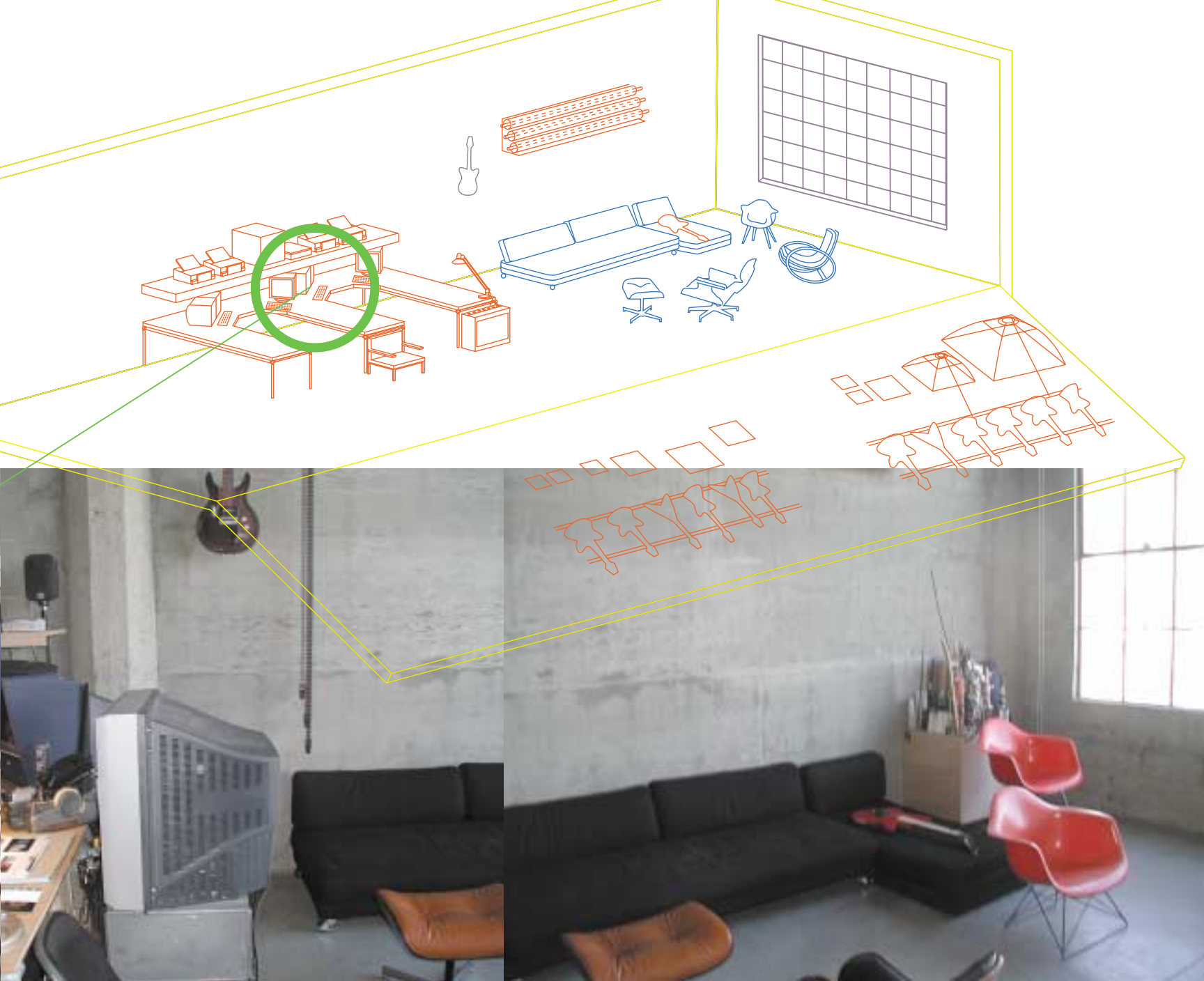

fig. F

NOTES:

¹**Goodform chair** A chair produced by General Fireproofing Co. of Youngstown, OH. The plant operated from 1902-1990. The classic '60s model consisted of an aluminum frame and Naugahyde upholstery (in Technicolor greens, yellows, and red). Like its rube Steelcase cousins, Goodform chairs were heavy-duty, incombustible office furniture for the modern skyscraper.

²**Mies van der Rohe** German-American architect (1886-1969). One of the Bauhaus posse, Mies [architects who talk about him like he's their uncle say it like this: Meez] was the leading exponent of the glass and steel über alles office building in which you're ticking off your days. Refer to the simplicity and exposed structural elements of the Farnsworth House, 1950, and the Seagram Building, 1958. He also designed the Barcelona chair found in advertising agencies everywhere.

³**The Hollaender Mfg.** 10285-T Wayne Ave., Box 156399, Cincinnati, OH 45215 phone (800) 723-8493; www.hollaender.com.

⁴**Global Supply** The industrial Pottery Barn. 590 Ansin Blvd., Hallandale, FL 33009; phone (954) 454-1234, www.gscusa.com.

⁵**Medium-density fibreboard** MDF can be cut easily without any breakout or splintering. Its mirror-smooth surfaces are ideal for painting, veneering, laminating, grain printing, and staining. MDF is composed of softwood bound with a urea formaldehyde resin. The conventional wisdom is that it releases an acceptable level of toxicity for indoor use (i.e., no more than air freshener). Potential health hazards of MDF:

- Possible inhalation of wood dust (8-hour occupational exposure limit) during machining and cutting of MDF.
- Inhalation of formaldehyde contained in the product and used in its manufacture. While hardwood dust in rare

instances can cause nasal cancer, the evidence that softwood dust can cause cancer is less conclusive.

⁶**Charles (1907-78) and Ray Eames (1912-88)**

If you haven't already seen it, please go in search of *Powers of Ten*, the sci-fi-cum-design film this mid-century modern "it" couple made in the '60s. You can order a copy online at www.powersof10.com. You'll thank us for this.

⁷**Circa50** Lounge-era furniture shipped for free: www.circa50.com.

⁸**Holophane** 214 Oakwood Ave., Newark, OH. 43055 (740) 349 - 4130; www.holophane.com

⁹**High-intensity discharge** Get your mind out of the gutter. High-intensity discharge lighting uses very high temperature to vaporize salts of various metals. The vapor conducts electrons and gives off different colors of light depending on the mix of salts. HID lighting produces 110 lumens per 1 watt of power.

UN

MADE

43 PEOPLE WHO RECEIVE MAIL AT MY HOUSE

by Evan Ratliff



NONE of the following 43 persons, businesses, or families currently resides—nor have they resided since August 1998—at 507 Fell St. in the city of San Francisco. Nonetheless, these persons, businesses, and families continue to receive U.S. Postal Service-delivered mail at that address.

The sheer volume and diversity of mail cannot reflect mere errors in the USPS forwarding system. By my estimation the ongoing arrival of this postal bounty at 507 Fell St. can only involve an intentional effort, on the part of the above-mentioned persons, businesses, and families, to receive mail at this address.

That said, if you are included on this list and believe you will at some later point be able to recover your letters, I'm terribly sorry. Due to the amount of mail received for nonresidents I am unable to retain it. If you or someone you know would like to have your mail sent to my house the address is: (Your Name) 507 Fell St., San Francisco, CA 94102 (No calls, please. We are unable to accommodate electronic mail at this time.)

1. Carolyn Anderson
2. Courtney E. Attel
3. Bell Reis Interiors
4. Dena Benton
5. Leonardo V. Birog
6. S.L. (or Sandra) Cantu, also S. Canter (presumed to be a misspelling)
7. Anne Carney
8. June Hee Choi
9. Coleman Cuff*
10. Bryant Daniels
11. Brion Donton
12. Exodus Chapter 278 OES
13. Dianna (or Deanna) Fleisher
14. Daniel Fleysher
15. Brigid Gorsky

16. Gerald L. Goshorn
17. Charlie Hodge
18. John E. Holmes**
19. Tiffany Howell
20. C. James
21. The Jim Family
22. Chris Kopacz
23. Karen Kowalski
24. Conor G. Laffan
25. Sarah Lazar*
26. Leah Lortie*
27. Dube McCormick
28. Meredith McManama
29. Elizabeth Michaels
30. Sarah Elizabeth Moses
31. Marissa Neff

32. Brian O'Rourke*
 33. Ingrid Lucille Peterson
 34. John P. Reis
 35. Declan Rennick
 36. Emmet Rennick
 37. Sales/Advertising Manager, PCJ Holdings
 38. Doris Sallay
 39. Timothy (or Tim) Shannon
 40. Heather D. Simmonds
 41. Jessica Hope Slovak*
 42. Jessica Tracy
 43. Sister Shirley Williams
- * Receives mail almost daily
** Possibly a joke

! EVAN RATLIFF !

EVAN RATLIFF wrote about the history of Rhodesian carpet in the last issue of *ReadyMade*. Evan Ratliff is the man standing right behind you, just to the left. **EVAN RATLIFF INJURES EYES, SKIN, AND MUCOUS MEMBRANES ON CONTACT. HARMFUL IF SWALLOWED.** Evan Ratliff is currently hard at work on his second book, *Friendly! The Unauthorized Biography of Kob Lobsterfree*. Evan Ratliff is a freelance writer and photographer living in the small of your back. Evan Ratliff once found a slightly dirty mattress lying on the street and brought it home to keep as an "extra," for "when guests come over." (After several months, he threw it out.) Someone named Evan Ratliff (no relation to the author) is a best friend of Shea, an eighth-grader at Paragould Junior High School. More information on Shea and Evan (no relation) and their adventures is available at expage.com/page/shea205. Evan Ratliff's only window faces a wall, that's why. Evan Ratliff is the editor in chief of *ReadyMade*. Evan Ratliff is the author of 3 1/2" pamphlets and talking points, most recently *Training My Dog to Make Bacon and Other Tales from a Paper Raft on the Caspian Sea*. Evan Ratliff is the assistant manager of Theodore "Ted" Danson's 2004 Senate campaign: "I'm Chancin' With Danson!" **EVAN RATLIFF™** is a registered trademark of JohnnyBigtime Corp. Any rights not expressly granted herein are reserved. Evan Ratliff would open up to you if you would only let him. Why do you keep shutting him out? All he wants to do is be a part of your life. Soon you're going to look around and there's going to be nobody. Will you be happy then? Evan Ratliff doesn't think so. Evan Ratliff, a freelance writer and photographer in San Francisco, is working on his bio. It's taken him some time to think of the many wonderful things he is and does, but he finally got them down on paper.



What We Were THINKING

A monthly index of influences, roadside attractions, and arcana that plug up the drafty, hole-punched parts of our brain.

FLEA MARKETS

New York	WHEN	WHERE	CONTACT
I.S. 44 Greenflea	Every Sun.	Columbus Ave. bet. 76th and 77th Sts.	(212) 721-0900
The Garage	Every Sat. and Sun.	112 West 125th St.	(212) 647-0707
SoHo Flea Market	Sat., Sun., and holidays 10 a.m.–6 p.m.	503 Broadway, bet. Spring and Broome Sts.	
SoHo Antiques and Collectibles Fair	Sat. and Sun. 9 a.m.–5 p.m.	Broadway and Grand St.	
P.S. 321 Flea Market	Sat. and Sun.	Seventh Avenue at 1st St. Brooklyn, NY 11215	
Los Angeles Area			
Outdoor Antiques and Collectible market	Third Sunday of the month	Long Beach Veterans Stadium, 5000 Lew Davis St. at Lakewood	
Northridge Antique Market	Fourth Sun. of the month, plus special fifth show on fifth Fri. of the month	18000 Devonshire at Lindley	(562) 633-3836
San Francisco Bay Area			
San Francisco Flea Market	Sat. and Sun.	140 S. Van Ness at Mission	(415) 646-0544
Alemany Flea Market	Sat. (fruit) Sun. (antiques, collectibles)	100 Alemany Blvd.	(415) 647-2043
Berkeley Flea Market	Every weekend 7 a.m.–7 p.m.	1937 Ashby Ave. Berkeley, CA	(510) 644-0744
San Diego			
Koby's Swap Meet at the Sports Arena	Every Thurs. through Sun.	3500 Sports Arena Blvd.	(619) 226-0650
New Orleans			
Jeff Indoor Flea Market	Every Fri., Sat., and Sun.	5501 Jefferson Highway	(504) 734-0087
French Market	Daily	French Quarter from Cafe Du Monde [at Old Jackson Square] to the river	(504) 522-2621
Philadelphia			
Roosevelt Mall Flea Market	Every Sun. June–October	2329 Cottman Ave.	(215) 331-2000
Atlanta			
Atlanta Flea Market	Every Fri., Sat., and Sun.	5360 Peachtree Industrial Blvd.	(707) 458-0456
Lakewood Fairgrounds Antiques Market	Second Sat. and Sun.	Lakewood Fairgrounds 2000 Lakewood Wy.	(404) 622-4488
Pendergrass Old Town Flea Market	Every Fri. and Sat.	Just north of Atlanta on I-85 at exit 50	(208) 939-6426
Seattle			
Fremont Sunday Market	Every Sat. and Sun.	Downtown Fremont Green Lake Exit off 99 N.	(206) 282-5706

MAGAZINES

loud paper.....New Scientist
Slow Food.....If/Then
McSweeney's.....Open City
Stay Free.....Adbusters
Arkitip.....Colors

BOOKS

Tibor Peter Hall, Ed.
S,M,L,XL Rem Koolhaas
Do-It-Yourself, Home Improvement in 20th Century America Carolyn M. Goldstein
Open Here: The Art of Instructional Design Paul Mijksenaar and Piet Westendorp
Marcel Duchamp, Artist of the Century Rudolf E. Kuenzli and Francis M. Naumann, Eds.

ONLINE

Museums and Galleries

PS1: www.ps1.org
Dia Center for the Arts: www.diacenter.org
Museum of Bad Art: www.glyphs.com/moba

Magazines

Modern Humorist: www.themodernhumorist.com
Animal Stories/Mall Punk: www.animalstories.com
Kaliber1000: www.k10k.com

Manifestos

A social and psychological explanation of "Giant Has a Posse," by Shepard Fairey: www.obeygiant.com/manifesto
Dogme 95: www.dogme95.dk/menu/menuset.htm

Buy Art

Eyestorm: www.eyestorm.com
Mixed Greens: www.mixedgreens.com

Architecture

Archinect: www.archinect.com
Low Country Guidance: www.lowcountryguidance.com
The Fat Channel: www.fat.co.uk

Furniture

Gallery of Obscure Patents: www.delphion.com/gallery
Design Object: www.designobject.com
Tarabox: www.tarabox.com/eng/index.html
Super Happy Bunny: www.superhappybunny.com
Pure Design: www.pure-design.com
Totem: www.totemdesign.com

Projects

Stamen: www.stamen.com
Superbad: www.superbad.com
Fake ID: www.fake-i-d.com/index2.html
Chunk Industries: www.multimedia.vt.edu/cella

Materials, Signage, Lab Supplies

Glue This to That: www.thisisthat.com
American Science and Surplus: www.sciplus.com
Edmund Scientific: www.scientificsonline.com
Mr. French: www.mrfrench.com
Papershop: www.papershops.com
The Lamp Shop: www.lampshop.com
Nu-Del Manufacturing: www.nu-dell.com
Rubber Stamp Man: www.rubberstampman.com
Tap Plastics: www.tapplastics.com
Adobe Palm-Size Press: www.wetmore-printing.com/TipTricks/PalmSize/main.html
Print Gocco: www.gocco.com

Recycling, Reuse

Recycler's World: www.recycle.net
Paperhaus: www.paperhaus.com
The Art and Science of Dumpster Diving: [www.geocities.com/CollegePark/ Union/7807](http://www.geocities.com/CollegePark/Union/7807)
DIY stop junk mail, email, and phone calls: www.obviously.com/junkmail/index.html

CATALOGS

Global Industrial Equipment
(800) 645-2986

SuperCircuits Video Security
(800) 335-9777

Consolidated Plastics
(800) 362-1000

Tek Supply
(800) 835-7877

Jimmy Corrigan, or, the Smartest Kid on Earth
Chris Ware

Painting by Numbers: Komar and Melamid's
Scientific Guide to Art JoAnn Wypijewski, Ed.

Pad: The Guide to Ultra-Living
Matt Maranian

Joseph Cornell/Marcel Duchamp...Resonance
Susan Davidson, Anne D'Harnoncourt, Lynda Roscoe Hartigan